

---

# Appendix 8

---

# State Planning Policy - Lot Plan Search

Making or amending a local planning instrument  
and designating land for community infrastructure

Date: 18/04/2023

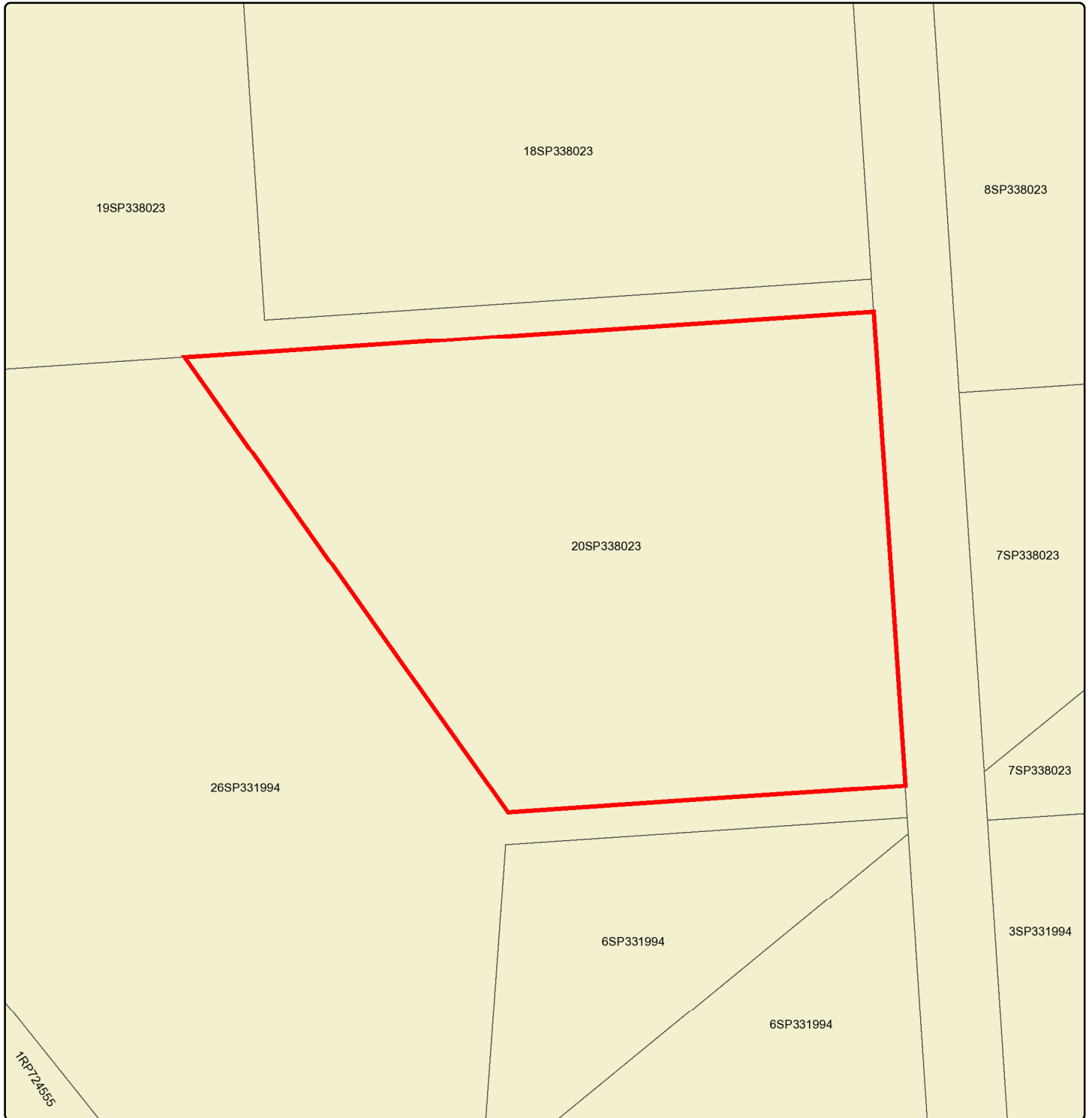

Queensland Government

© The State of Queensland 2023.

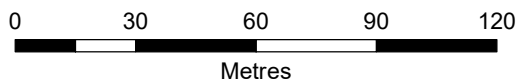

Disclaimer: This map has been prepared with due care based on the best available information at the time of publication. However, the State of Queensland (acting through the department) makes no representations, either express or implied, that the map is free from errors, inconsistencies or omissions. Reliance on information contained in this map is the sole responsibility of the user. The State disclaims responsibility for any loss, damage or inconvenience caused as a result of reliance on information or data contained in this map.

# State Planning Policy mapping layers - consolidated list for all selected Lot Plans

(Note: Please refer to following pages for State Interests listed for each selected Lot Plan)

## **DEVELOPMENT AND CONSTRUCTION**

- State development area

## **NATURAL HAZARDS RISK AND RESILIENCE**

- Flood hazard area - Level 1 - Queensland floodplain assessment overlay\*
- Flood hazard area - Local Government flood mapping area\*
- Bushfire prone area

## **STRATEGIC AIRPORTS AND AVIATION FACILITIES**

- Wildlife hazard buffer zone
- Height restriction zone 90m

## **STRATEGIC PORTS**

- Priority ports

## **PRIORITY PORTS**

- Townsville priority port precincts



Queensland Government

© The State of Queensland 2023.

## **State Planning Policy** Making or amending a local planning instrument and designating land for community infrastructure

Date: 18/04/2023

Disclaimer: This map has been prepared with due care based on the best available information at the time of publication. However, the State of Queensland (acting through the department) makes no representations, either express or implied, that the map is free from errors, inconsistencies or omissions. Reliance on information contained in this map is the sole responsibility of the user. The State disclaims responsibility for any loss, damage or inconvenience caused as a result of reliance on information or data contained in this map.

# State Planning Policy mapping layers for each selected Lot Plan

**Lot Plan: 20SP338023 (Area: 25180 m<sup>2</sup>)**

## DEVELOPMENT AND CONSTRUCTION

- State development area

## NATURAL HAZARDS RISK AND RESILIENCE

- Flood hazard area - Level 1 - Queensland floodplain assessment overlay\*
- Flood hazard area - Local Government flood mapping area\*
- Bushfire prone area

## STRATEGIC AIRPORTS AND AVIATION FACILITIES

- Wildlife hazard buffer zone
- Height restriction zone 90m

## STRATEGIC PORTS

- Priority ports

## PRIORITY PORTS

- Townsville priority port precincts



Queensland Government

© The State of Queensland 2023.

## State Planning Policy

Making or amending a local planning instrument  
and designating land for community infrastructure

Date: 18/04/2023

Disclaimer: This map has been prepared with due care based on the best available information at the time of publication. However, the State of Queensland (acting through the department) makes no representations, either express or implied, that the map is free from errors, inconsistencies or omissions. Reliance on information contained in this map is the sole responsibility of the user. The State disclaims responsibility for any loss, damage or inconvenience caused as a result of reliance on information or data contained in this map.